

Diocese of Boise



Safe Environment Program

Safe Environment Instructions:

1. Go to <http://boise.CMGconnect.org> to complete your new online safe environment curriculum.
2. Create a new account by completing all the boxes. This includes address, primary parish, and how you participate at your parish or school. If you have questions please contact your parish/school administrator.
3. Start the *Safe Environment Training—Diocese of Boise*.

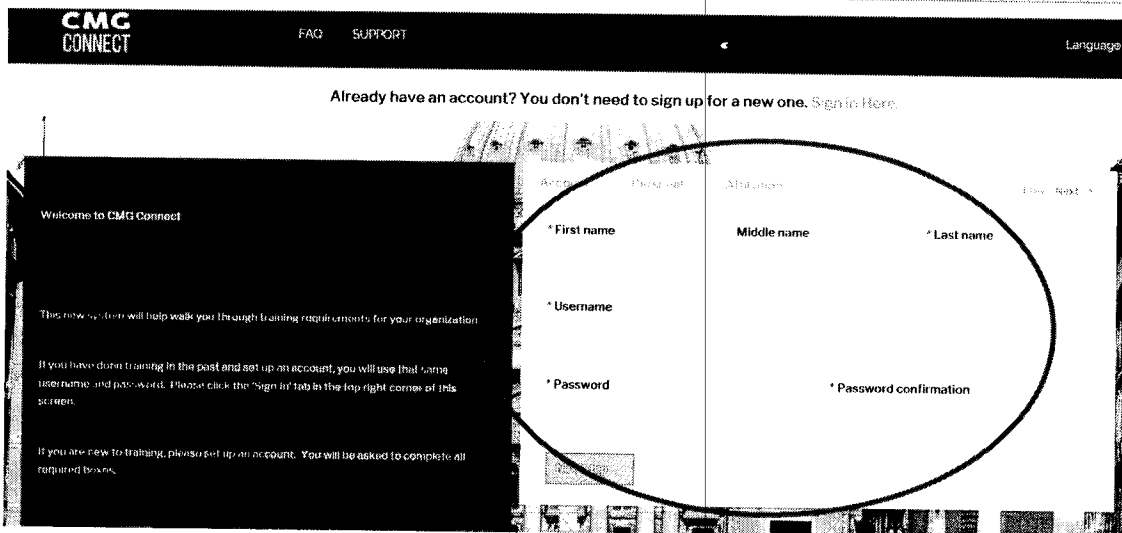

- You will progress through ALL three account creation screens before your registration is complete.
- On your main dashboard, you will Start Curriculum.
- Complete all sections—as you work through they will show as 'Done' in each box.

Required Trainings

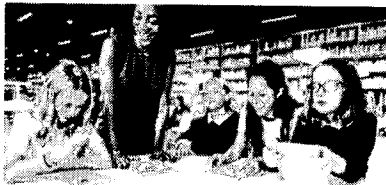

A. Safe Environment Training - Diocese of Boise



Includes: USCCB role selection; Safe Haven - It's Up to You video segments, video questions, acknowledgement.



[▶ Start Curriculum](#)

Training Overview
Registration Acknowledgement

Safe Haven - It's Up to You
Segment 1
Video Page

Safe Haven Questions 1
Question Answer Page

Safe Haven - It's Up to You
Segment 2
Video Page

Safe Haven Questions 2
Question Answer Page

Safe Haven - It's Up to You
Segment 3
Video Page

Safe Haven Questions 3
Question Answer Page

Decree of Promulgation
Read and Sign Page

www.boise.CMGconnect.org